



jordanfishwick

Chatsworth House, Manchester, M1 1BY
£1,050 Per Calendar

- Available Mid January
- NQ Location
- Council Tax Band D

- First Floor Apartment - Corner Aspect
- Furnished
- City Centre Location

- Two Bedrooms
- No Parking
- Close to Transport Links

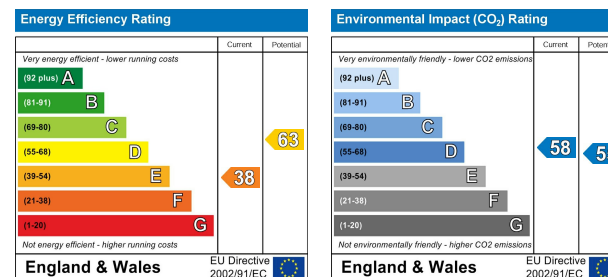

These particulars are believed to be accurate but they are not guaranteed and do not form a contract. Neither Jordan Fishwick nor the vendor or lessor accept any responsibility in respect of these particulars, which are not intended to be statements or representations of fact and any intending purchaser or lessee must satisfy himself by inspection or otherwise as to the correctness of each of the statements contained in these particulars. Any floorplans on this brochure are for illustrative purposes only and are not necessarily to scale.

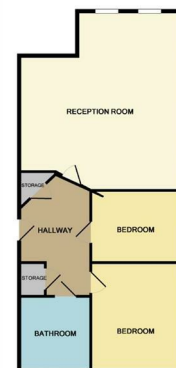

Measurements are approximate. Not to scale. Illustrative purposes only. Made with Metaphor (2017).



These particulars are believed to be accurate but they are not guaranteed and do not form a contract. Neither Jordan Fishwick nor the vendor or lessor accept any responsibility in respect of these particulars, which are not intended to be statements or representations of fact and any intending purchaser or lessee must satisfy himself by inspection or otherwise as to the correctness of each of the statements contained in these particulars. Any floorplans on this brochure are for illustrative purposes only and are not necessarily to scale.

Offices at: Chorlton, Didsbury, Disley, Hale, Glossop, Macclesfield, Manchester Deansgate, Manchester Whitworth Street, New Mills, Sale, Wilmslow and Withington

68 The Arches, Whitworth St West, Manchester, M1 5WQ

0161 833 9499 opt 2

manchester@jordanfishwick.co.uk
www.jordanfishwick.co.uk